

native pollinator garden at Pfeiffer University,
 installed Spring 2023 by Reconciliation Ecology class,
 led by Dr. Carrie DeJaco

Harris Annex, facing Stokes

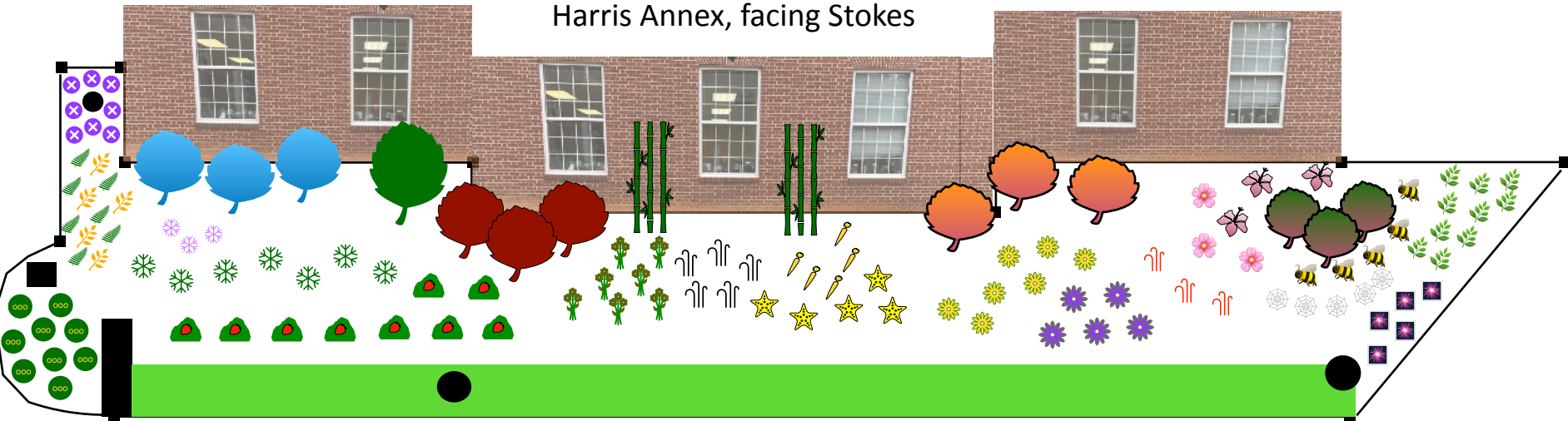

- | | | | |
|--------------------|--------------------|-------------------|-------------|
| common blue violet | leucothoe | golden Alexander | milkweed |
| Christmas fern | wild strawberry | coreopsis | winterberry |
| wreath goldenrod | Florida anise | fothergilla | bee balm |
| green-and-gold | oak-leaf hydrangea | black-eyed susan | verbena |
| purple phacelia | crossvine | purple coneflower | yarrow |
| white wood aster | columbine | scarlet sage | spiderwort |
| | beardtongue | hibiscus | |

Icons do not reflect numbers of plants,
 but simply the general area of the
 species in the garden as of May 2024.